

"CITY'S ORIGINAL"

Agmt. No. 006053070

A G R E E M E N T

Union Pacific Railroad Company
Crossing Signals and Gates

Project No. 87 X-2438-01
STP-X243(801)
Sedgwick County, Kansas

Agreement between the Union Pacific Railroad Company, the City of Wichita, Sedgwick County, Kansas and the Secretary of Transportation of the State of Kansas, relative to the construction and maintenance of Highway Crossing Signals under Section 130, United States Code 23.

* * * * *

This agreement, made and entered into this _____ day of _____, by and between the Union Pacific Railroad Company, a Delaware Corporation, hereinafter referred to as the "Company", the City of Wichita, Sedgwick County, Kansas hereinafter referred to as the "City", and the Secretary of Transportation of the State of Kansas, hereinafter referred to as the "Secretary".

WITNESSETH:

WHEREAS, the Secretary proposes to submit to the Federal Highway Administration of the United States Department of Transportation a project providing for the installation of railway-highway crossing signals, flashing light straight post type and gates in front of the existing cantilever signals at a grade crossing (DOT #439347B) on Hillside Avenue in the City of Wichita, Sedgwick County, Kansas, said project to be known and designated as Project No. 87 X-2438-01; STP-X243(801) and more particularly described as follows:

- . at the intersection of Hillside Avenue and the Company's tracks approximately 1400 feet north of the Southeast Corner of Section 34, Township 26 South, Range 1 East, in the City of Wichita, Sedgwick County, Kansas,

and will recommend its approval for construction under Section 130, United States Code 23 and amendments thereto, and

WHEREAS, the locations for the warning devices were determined by a diagnostic team consisting of representatives of the Company, the City, and the Secretary, and

NOW, THEREFORE, in consideration of the premises and the mutual covenants herein contained, and subject to the approval of the Federal Highway Administration, it is hereby agreed by the parties hereto:

1. The total cost of the project will be funded one-hundred percent (100%) using Federal Section 130 Funds, including preliminary engineering, construction, sales tax, users tax and such other items as are properly chargeable to the project under Section 130, United States Code 23 and amendments thereto.

2. The City will install and maintain the advance warning signs.

3. The Company will provide the Secretary with a copy of the bill of materials and the detailed estimate of the cost of the project. The estimate to be attached to and become a part of this agreement.

4. After being notified by the Secretary that the project has been approved and that work may begin, the Company will notify the Secretary's District Engineer, Mr. Robert Cook, Hutchinson, Kansas, at least one week in advance of the date that work on the project is to be started, and should withdrawal from the project become necessary for any reason, the Company will each time notify the Secretary's District Engineer of the date that work on the project is to be resumed.

5. The Company install the new flashing light straight post type signals and gates in front of the existing cantilever signals and make all connections necessary for their successful operation, and do all incidental and appurtenant work in accordance with the project and the "Manual on Uniform Traffic Control Devices". The Company will furnish all of the material and do all of the work with its own forces, or the work may be done by a contractor paid under a contract let by the Company in compliance with the provisions of 23 C. F. R., Chapter I, Subchapter B, Part 140, Subpart I. Said Title 23 Code of Federal Regulations (23 C. F. R.) is by reference made a part of this agreement. If this work is to be done by a contractor paid under a contract let by the Company, prior written approval shall be obtained from the Secretary. The estimated schedule by the Company for the completion of the work for this project is one year from the date of this agreement.

6. The Company will keep detailed and accurate records of all labor, materials, supplies, incidentals and all other necessary costs involved in carrying out the work performed by the Company under the terms of this agreement, and will give access to such records at any time during regular office hours to any authorized representative of the Secretary or of the Federal Highway Administration, for a period of three years from the date final payment has been received by the Company.

7. Preparation of preliminary estimates, procurements, performance of work, expenditures, billing and reimbursement shall all be done in accordance with 23 C. F. R., Chapter I, Subchapter B, Part 140, Subpart I.

8. The Company will submit to the Secretary's District Engineer, Mr. Robert Cook, Hutchinson, Kansas, a final and complete billing of the incurred costs within one year after the completion of the work, and the Secretary will pay an amount equal

to the total cost of the project, with the understanding that the Company will reimburse the Secretary for one hundred percent (100%) of the amount of all items in the Company's bill which are declared by the Federal Highway Administration to be ineligible for participation in Federal Funds.

9. The Company shall have title to the signals and gates and crossing surface and at its own cost and expense will maintain the signals and gates and crossing surface and will make ample provision each year for such maintenance, provided, however, the Company shall be entitled to receive any contribution toward the cost of such maintenance as may be now, or hereafter made available by reason of any law, ordinance, regulation, order, grant or by other means or sources.

10. The parties hereto do hereby agree that the "Special Attachment No. 1" herewith, pertaining to the implementation of Title VI of the Civil Rights Act of 1964, is hereby made a part of this agreement.

11. The Company does agree that the "Special Attachment No. 2" herewith, pertaining to lobbying, is hereby made a part of this agreement.

12. It is further understood that this agreement and all contracts entered into under the provisions of this agreement shall be binding upon the City, Company and the Secretary and their successors and assigns.

IN WITNESS WHEREOF, the parties hereto have caused this agreement to be executed in triplicate by their proper offices on the day and year first herein written.

DEBRA L. MILLER
SECRETARY OF TRANSPORTATION

BY: _____
G. DAVID COMSTOCK, P.E.
DIRECTOR OF ENGINEERING
AND DESIGN

UNION PACIFIC RAILROAD
COMPANY

BY: Thomas J. Gee
TITLE: AVP ENGINEERING

ATTEST:

BY ACTION OF THE CITY COUNCIL

CITY CLERK

Carlos Mayans, Mayor

APPROVED:
Gary L. Robertson ✓

KANSAS DEPARTMENT OF TRANSPORTATION

Special Attachment
To Contracts or Agreements Entered Into
By the Secretary of Transportation of the State of Kansas

NOTE: Whenever this Special Attachment conflicts with provisions of the Document to which it is attached, this Special Attachment shall govern.

THE CIVIL RIGHTS ACT OF 1964, and any amendments thereto,
REHABILITATION ACT OF 1973, and any amendments thereto,
AMERICANS WITH DISABILITIES ACT OF 1990, and any amendments thereto,
AGE DISCRIMINATION ACT OF 1975, and any amendments thereto,
EXECUTIVE ORDER 12898, FEDERAL ACTIONS TO ADDRESS ENVIRONMENTAL JUSTICE IN
MINORITY POPULATIONS AND LOW INCOME POPULATIONS (1994), and any amendments thereto,
49 C.F.R. Part 26.1 (DBE Program), and any amendments thereto

NOTIFICATION

The Secretary of Transportation for the State of Kansas, in accordance with the provisions of Title VI and Title VII of the Civil Rights Act of 1964 (78 Stat. 252), §504 of the Rehabilitation Act of 1973 (87 Stat. 3555) and the Americans with Disabilities Act of 1990 (42 USC 12101), the Age Discrimination Act of 1975 (42 USC 6101), the Regulations of the U.S. Department of Transportation (49 C.F.R., Part 21, 23, and 27), issued pursuant to such ACT, Executive Order 12898, Federal Actions to Address Environmental Justice in Minority Populations and Low Income Populations (1994), and the DBE Program (49 C.F.R., Part 26.1), hereby notifies all contracting parties that, the contracting parties will affirmatively insure that this contract will be implemented without discrimination on the grounds of race, religion, color, gender, age, disability, national origin, or minority populations and low income populations as more specifically set out in the following seven "Nondiscrimination Clauses".

CLARIFICATION

Where the term "consultant" appears in the following seven "Nondiscrimination Clauses", the term "consultant" is understood to include all parties to contracts or agreements with the Secretary of Transportation of the State of Kansas.

Nondiscrimination Clauses

During the performance of this contract, the consultant, or the consultant's assignees and successors in interest (hereinafter referred to as the "Consultant"), agrees as follows:

- (1) Compliance with Regulations: The consultant will comply with the Regulations of the U. S. Department of Transportation relative to nondiscrimination in federally-assisted programs of the U.S. Department of Transportation (Title 49, Code of Federal Regulations, Parts 21, 23 and 27,

hereinafter referred to as the Regulations), which are herein incorporated by reference and made a part of this contract.

- (2) Nondiscrimination: The consultant, with regard to the work performed by the consultant after award and prior to the completion of the contract work, will not discriminate on the grounds of race, religion, color, gender, age, disability, national origin or minority populations and low income populations in the selection and retention of subcontractors, including procurements of materials and leases of equipment. The consultant will not participate either directly or indirectly in the discrimination prohibited by Section 21.5 of the Regulations, including employment practices when the contract covers a program set forth in Appendix B of the Regulations.
- (3) Solicitations for Subcontractors, Including Procurements of Material and Equipment: In all solicitations, either competitive bidding or negotiation made by the consultant for work to be performed under a subcontract including procurements of materials and equipment, each potential subcontractor or supplier shall be notified by the consultant of the consultant's obligation under this contract and the Regulations relative to nondiscrimination on the grounds of race, religion, color, gender, age, disability, national origin or minority populations and low income populations.
- (4) Information and Reports: The consultant will provide all information and reports required by the Regulations, or orders and instructions issued pursuant thereto, and the Secretary of the Transportation of the State of Kansas will be permitted access to the consultant's books, records, accounts, other sources of information, and facilities as may be determined by the Secretary of Transportation of the State of Kansas to be pertinent to ascertain compliance with such Regulations, orders and instructions. Where any information required of a consultant is in the exclusive possession of another who fails or refuses to furnish this information, the consultant shall so certify to the Secretary of Transportation of the State of Kansas and shall set forth what efforts it has made to obtain the information.
- (5) Employment: The consultant will not discriminate against any employee or applicant for employment because of race, religion, color, gender, age, disability, or national origin.
- (6) Sanctions for Noncompliance: In the event of the consultant's noncompliance with the nondiscrimination provisions of this contract, the Secretary of Transportation of the State of Kansas shall impose such contract sanctions as the Secretary of Transportation of the State of Kansas may determine to be appropriate, including, but not limited to,
 - (a) withholding of payments to the consultant under the contract until the contractor complies, and/or
 - (b) cancellation, termination or suspension of the contract, in whole or in part.
- (7) Disadvantaged Business Obligation

- (a) Disadvantaged Businesses as defined in the Regulations, shall have a level playing field to compete fairly for contracts financed in whole or in part with Federal funds under this contract.
 - (b) All necessary and reasonable steps shall be taken in accordance with the Regulations to ensure that Disadvantaged Businesses have equal opportunity to compete for and perform contracts. No person(s) shall be discriminated against on the basis of race, color, gender, or national origin in the award and performance of federally-assisted contracts.
 - (c) The contractor, sub recipient or subcontractor shall not discriminate on the basis of race, color, national origin, or sex in the performance of this contract. The contractor shall carry out applicable requirements of 49 CFR Part 26 in the award and administration of Federally-assisted contracts. Failure by the contractor to carry out these requirements is a material breach of this contract, which may result in the termination of this contract or such other remedy, as the recipient deems appropriate.
- (8) Executive Order 12898
- (a) To the extent permitted by existing law, and whenever practical and appropriate, all necessary and reasonable steps shall be taken in accordance with Executive Order 12898 to collect, maintain, and analyze information on the race, color, national origin and income level of persons affected by programs, policies and activities of the Secretary of Transportation of the state of Kansas and use such information in complying with this Order.
- (9) Incorporation of Provisions: The consultant will include the provisions of paragraphs (1) through (8) in every subcontract, including procurements of materials and equipment, unless exempt by the Regulations, order, or instructions issued pursuant thereto. The consultant will take such action with respect to any subcontract or procurement as the Secretary of Transportation of the State of Kansas may direct as a means of enforcing such provisions including sanctions for noncompliance: PROVIDED, however, that, in the event a consultant becomes involved in, or is threatened with, litigation with a subcontractor or supplier as a result of such direction, the consultant may request the State to enter into such litigation to protect the interests of the State.

CERTIFICATION FOR FEDERAL-AID CONTRACTS

The prospective participant certifies, by signing and submitting this bid or proposal, to the best of his or her knowledge and belief, that:

- (1) No Federal appropriated funds have been paid or will be paid, by or on behalf of the undersigned, to any person for influencing or attempting to influence an officer or employee of any Federal agency, a Member of Congress, an officer or employee of Congress, or an employee of a Member of Congress in connection with the awarding of any Federal contract, the making of any Federal grant, the making of any Federal loan, the entering into of any cooperative agreement, and the extension, continuation, renewal, amendment, or modification of any Federal contract, grant, loan, or cooperative agreement.
- (2) If any funds other than Federal appropriated funds have been paid or will be paid to any person for influencing or attempting to influence an officer or employee of any Federal agency, a Member of Congress, an officer or employee of Congress, or an employee of a Member of Congress in connection with this Federal contract, grant, loan, or cooperative agreement, the undersigned shall complete and submit Standard Form-LLL, "Disclosure Form to Report Lobbying," in accordance with its instructions.

This certification is a material representation of fact upon which reliance was placed when this transaction was made or entered into. Submission of this certification is a prerequisite for making or entering into this transaction imposed by Section 1352, Title 31, U.S. Code. Any person who fails to file the required certification shall be subject to a civil penalty of not less than \$10,000 and not more than \$100,000 for each such failure.

The prospective participant also agrees by submitting his or her bid or proposal that he or she shall require that the language of this certification be included in all lower tier subcontracts, which exceed \$100,000 and that all such subrecipients shall certify and disclose accordingly.

DATE: 2006-10-09

ESTIMATE OF MATERIAL AND FORCE ACCOUNT WORK
 BY THE
 UNION PACIFIC RAILROAD

THIS ESTIMATE GOOD FOR 6 MONTHS EXPIRATION DATE IS :2007-04-09

DESCRIPTION OF WORK:
 UPGRADE EXISTING CROSSING BY ADDING LED FL SIGNALS W/GATES AT HILLSIDE
 AVE. IN WICHITA, KS. M.P. 480.50 ON THE WICHITA IND. LEAD
 SIGNAL PROJECT MANAGER: GAIL NELSON 252-6233
 RAILROAD TO PERFORM ALL WORK / COST DISTRIBUTED AS FOLLOWS:
 SIGNAL - FEDERAL GOVERNMENT 100% RECOLLECTIBLE

PID: 54411 AWO: 55916 MP,SUBDIV: 480.50, WICHITA
 SERVICE UNIT: 07 CITY: WICHITA STATE: KS

DESCRIPTION	QTY	UNIT	LABOR	MATERIAL	RECOLL.	UPRR	TOTAL
ENGINEERING WORK							
ENGINEERING			2299		2299		2299
LABOR ADDITIVE 100%			7035		7035		7035
SIG-HWY XMG			4215		4215		4215
TOTAL ENGINEERING			13549		13549		13549
SIGNAL WORK							
HILL PREP			900		900		900
CONTRACT				3463	3463		3463
EARTH FILL/ROCK				500	500		500
LABOR ADDITIVE 100%			32283		32283		32283
METER SERVICE				1600	1600		1600
PERSONAL EXPENSES				25125	25125		25125
RAISE POWER LINE				10000	10000		10000
SALES TAX				1696	1696		1696
SIDEWALK				5000	5000		5000
SIGNAL			29892	34630	64522		64522
TRANSPORTATION CHARGES				2550	2550		2550
WE TRAFFIC CONTROL				10000	10000		10000
TOTAL SIGNAL			63075	94564	157639		157639
LABOR/MATERIAL EXPENSE			76624	94564			
RECOLLECTIBLE/UPRR EXPENSE					171188	0	
ESTIMATED PROJECT COST							171188
EXISTING REUSEABLE MATERIAL CREDIT					0		
SALVAGE NONREUSEABLE MATERIAL CREDIT					0		

RECOLLECTIBLE LESS CREDITS

THE ABOVE FIGURES ARE ESTIMATES ONLY AND SUBJECT TO FLUCTUATION. IN THE EVENT OF AN INCREASE OR DECREASE IN THE COST OR QUANTITY OF MATERIAL OR LABOR REQUIRED, UPRR WILL BILL FOR ACTUAL CONSTRUCTION COSTS AT THE CURRENT EFFECTIVE RATE.

FORM 30-1
 WORK ORDER AUTHORIZATION-DETAIL OF ESTIMATED EXPENDITURES

PAGE 04 MORE

RAILROAD: UPRR CO.
 LOCATION: WICHITA, KS, HILLSIDE AVE, WICHITA IND LD
 DEPARTMENT: ENGINEERING SERVICES

PROJ NO: 54411
 A.W.O. NO: 55916
 W.O. NO:
 B.I. NO: 06BN10
 STATE: KS
 VAL SEC: 1425

----- STOCK MATERIAL PLAN -----

ITEM NUMBER	ITEM DESCRIPTION	UNIT COST	QTY	UM	DIRECT MAIL \$
02040540	BATTERY, GNB, 75A13 OR 50A19, ABGO	224.93	14	EA	3149
05015690	CIRCUIT BREAKER, 120/240V 30A AC	5.94	1	EA	6
09065700	TAPE, ELECTRICAL PLASTIC	2.65	2	EL	5
09137100	TERM. LOG 3/16 CABLE-1/4 POST 2412	0.49	30	EA	15
09401140	ADAPTER, 4 INCH CARLOW PLASTIC	3.28	2	EA	7
09409820	BUSHING, 4" PLASTIC, INSULATING	0.80	2	EA	2
09424920	CONDUIT, 4", PVC, TYPE 40	2.30	100	LF	230
09467930	LOCKNUT, 4 INCH, GALVANIZED	5.17	2	EA	10
09844170	GROUND ROD, 5/8 INCH X 8 FEET	6.50	5	EA	33
09846750	GRND. ROD CONN. 4WAY ONESHOT.	4.84	5	EA	24
09908640	WIRE, #6 AWG. 1 COND. COPPER, SOLID	0.43	125	LF	54
09912200	WIRE #6 AWG 2 COND 500' ROLL SHIELDED	1.65	500	LF	825
09913200	WIRE, #6, 5 COND 500' ROLL SHIELDED	2.97	500	LF	1485
09915610	WIRE #6 AWG 1 COND COPPER, STRAN	0.50	150	LF	75
09930550	WIRE #10 AWG 1 COND COPPER, STRAN	0.20	650	LF	130
09932310	WIRE #10 AWG 1 COND COPPER, TWIST	0.42	120	LF	50
09945100	WIRE #14, 7 COND 500' ROLL SHIELDED	1.30	500	LF	650
09960090	WIRE #16 AWG 1 COND COPPER, STRAN	0.27	500	LF	135
17061400	PADLOCK, SIGNAL, WITHOUT KEY, AMERIC	14.53	6	EA	87
35040010	PLASTER OF PARIS, DENTAL GRADE	0.89	25	LB	22
52001370	SURGE PROTECTOR SP20-2A TAB 585	66.80	1	EA	67
52005700	BOND WIRE, 7 STRANDS 100 LF. ROLL	0.78	400	LF	312
52019530	ENCLOSURE, SHUNT, POLE MOUNTED. 24X2	162.46	3	EA	487
52019560	EQUALIZER, H.D. TAB 583	8.87	3	EA	27
52021950	FOUNDATION, 4', STEEL, FOR FLGHR/GAT	195.45	2	EA	391
52028420	LIGHTNING ARRESTOR, CLR-COMM TAB 3	6.74	10	EA	67
52029750	LIGHTNING ARR. HD TAB 582 W/O BASE	9.50	4	EA	38
52040400	RESISTOR, ADJ. 0.63 OHM TAB91	23.64	4	EA	95
52041430	RECTIFIER, 60EC. 60 AMP. CRAGG.	550.00	1	EA	550
52042650	POST, MOUNTING, FOR SHUNT HOUSING	11.77	6	EA	71
52070010	TERMINAL, #12-10 WIRE, RING TONGUE	0.08	250	EA	20
52071600	TERMINAL, #20-16 WIRE, RING TONGUE	0.07	100	EA	7
52072280	TERMINAL BLOCK, SIGNAL 2 POST BAR	2.25	36	EA	81
52074660	SWITCH, MCKERN TAB 82	13.90	1	EA	14
52079550	WIRE TAG, PLASTIC - WHITE	0.12	100	EA	12
52079560	MARKING PEN (FOR WHITE TAG)	1.95	1	EA	2
52108140	LED FL/GATE ASSY. 1W FRONT ONLY	6549.20	2	EA	13098
52109370	GATE ARM, ADJ. 16-32'	481.61	2	EA	963
52122140	HIGH WIND BRACKET 5" OR 4"	63.99	2	EA	128
52123700	FLASHING LIGHT UNIT, 12" LED COMP	278.53	16	EA	4456

WORK ORDER AUTHORIZATION-DETAIL OF ESTIMATED EXPENDITURES

RAILROAD: UPRR CO.
 LOCATION: WICHITA, KS, HILLSIDE AVE, WICHITA 1ND LD
 DEPARTMENT: ENGINEERING SERVICES

PROJ NO: 54411
 A.W.O. NO: 55916
 W.O. NO:
 B.I. NO: 06RN10
 STATE: KS
 VAL SEC: 1425

52136470	SHEAR PIN, SK-1000-1	5.50	2 EA	11
52246000	RESISTOR, 47,000 (47K) OHM .5 WATT	0.19	2 EA	0
52258850	NBS, TAB 642, 62775-3497	308.69	3 EA	926
52263690	SURGE PANEL - TAB 619	129.37	1 EA	129
52267000	TRANSCEIVER MODULE-#80012-GCP	1726.56	2 EA	3453
52745830	RELAY, TAB 884, NEUTRAL, A62-277	221.29	2 EA	443
52752390	RELAY, TAB 893, B1SR, A62-360,3 S	495.12	2 EA	810
52776370	RELAY PLANKBOARD, GRS B1, TAB 900	31.65	3 EA	95
52777970	FLAG TERMINAL, FOR GRS, 14-10	0.77	20 EA	15
52778110	FLAG TERMINAL, FOR GRS, 20-16	0.70	20 EA	14
52779280	RELAY TEST TERM, GRS B1	6.63	3 EA	20
52973500	TAB 925	500.00	1 EA	500
53954500	180429-000 BOOTLEG KIT	47.61	7 EA	333
	TOTAL			34,629

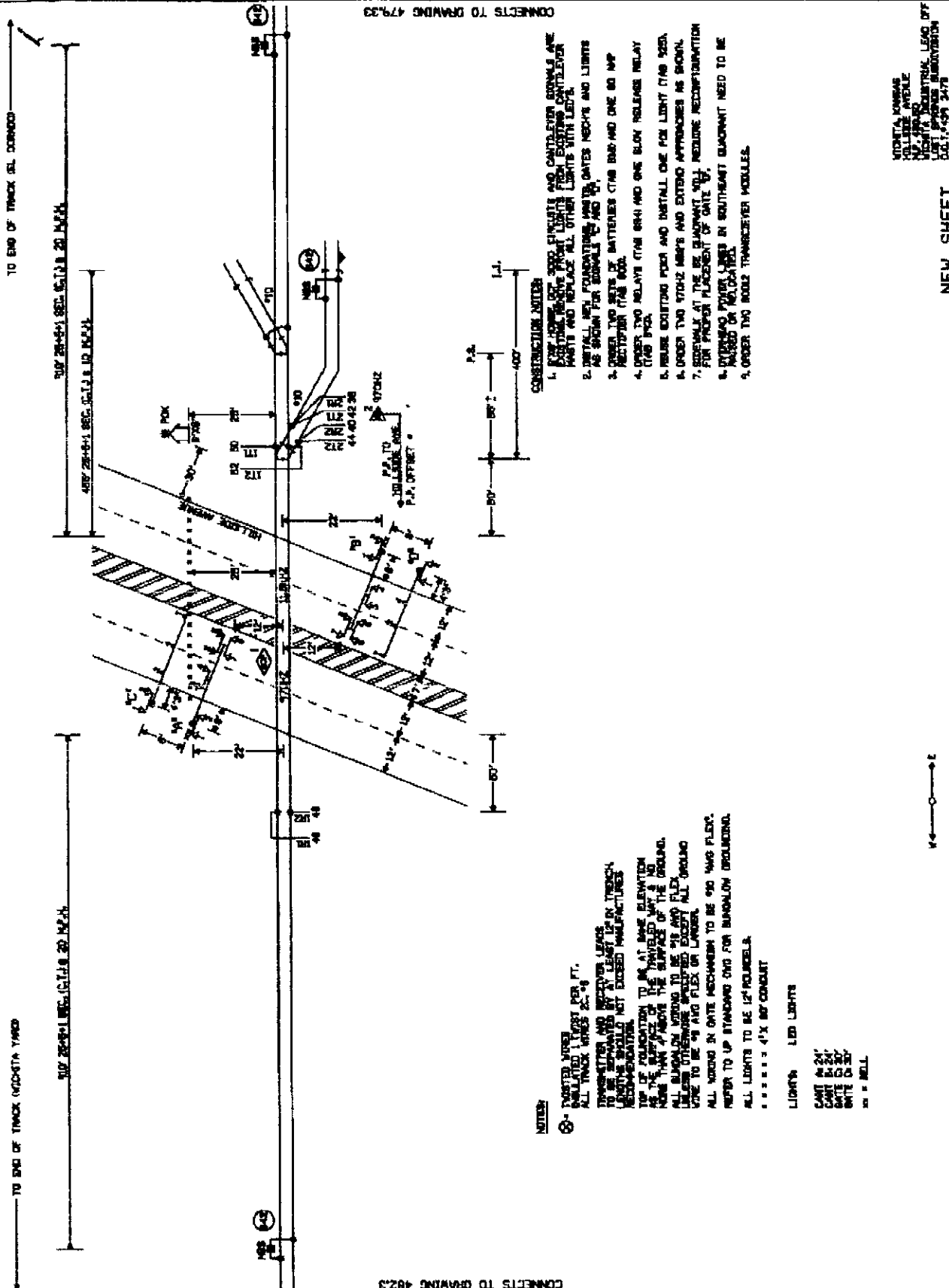

CONNECTS TO DRAWING 479.33

CONNECTS TO DRAWING 482.3

NOTES

- 1. TRANSIT VANE SHALL BE 10 FT. FROM TRACK CENTER LINE.
- 2. ALL TRACK SPACES 22'-0".
- 3. TRANSMITTER AND RECEIVER LEADS TO BE 1/2" DIA. AND SHALL NOT EXCEED MANUFACTURER'S RECOMMENDATION.
- 4. TOP OF FOUNDATION TO BE AT SAME ELEVATION AS THE SURFACE OF THE TRAVELLED WAY & NO MORE THAN 2" ABOVE THE SURFACE OF THE GROUND.
- 5. ALL SIGNALON WIRING TO BE #18 AWG FLEX UNLESS OTHERWISE SPECIFIED EXCEPT ALL GROUND WIRE TO BE #8 AWG FLEX OR LARGER.
- 6. ALL WIRING IN GATE MECHANISM TO BE #18 AWG FLEX.
- 7. REFER TO UP STANDARD AND FOR SIGNALON DIMENSIONS.
- 8. ALL LIGHTS TO BE 12" SQUARE.
- 9. ***** 4' X 8' CONDUIT

LIGHTS - LED LIGHTS

- 1. CASE 1/2" DIA.
- 2. CASE 1/2" DIA.
- 3. CASE 1/2" DIA.
- 4. CASE 1/2" DIA.
- 5. CASE 1/2" DIA.

CONSTRUCTION NOTES

- 1. THE ORDER OF THE SIGNALS AND GATE RELEASE SIGNALS ARE TO BE AS SHOWN ON THIS DRAWING FROM EAST TO WEST.
- 2. INSTALL NEW FOUNDATION AND GATE RELEASE AND LIMITS AS SHOWN FOR SIGNALS AND GATE RELEASE.
- 3. ORDER TWO SETS OF BATTERIES (750 600) AND ONE 80 AMP RECTIFIER (750 600).
- 4. ORDER TWO RELAYS (750 600) AND ONE SLOW RELEASE RELAY (750 600).
- 5. REMOVE EXISTING POLE AND INSTALL ONE FOR LIGHT (750 600).
- 6. ORDER TWO 500HZ WPS'S AND EXTEND APPROXIMATE AS SHOWN.
- 7. SIDEWALK AT THE 1/2" BLANKET WILL REQUIRE RECONFIGURATION FOR PROPER PLACEMENT OF GATE W.
- 8. EXISTING POWER LINES IN SOUTHEAST QUADRANT NEED TO BE MAINTAINED OR RELOCATED.
- 9. ORDER TWO 800V TRANSFORMER MODULES.



NEW SHEET

UNION PACIFIC RAILROAD		MICHITA, KANSAS		HIGH-WAY CROSSING SIGNALS		CONTROL CIRCUITS		S-1381	
DATE 5-28-58		SHEET 1		JOB NO. 44-40-42-36		DRAWN BY J.E. BLANKENHORN		CHECKED BY J.E. BLANKENHORN	
MICHITA, KANSAS		MICHITA, KANSAS		MICHITA, KANSAS		MICHITA, KANSAS		MICHITA, KANSAS	
MICHITA, KANSAS		MICHITA, KANSAS		MICHITA, KANSAS		MICHITA, KANSAS		MICHITA, KANSAS	
MICHITA, KANSAS		MICHITA, KANSAS		MICHITA, KANSAS		MICHITA, KANSAS		MICHITA, KANSAS	